



**QUINTA ESSENTIA**



# THE FIFTH ELEMENT.

## QUINTA ESSENTIA

... the fifth essence - superior to the four elements of earth, air, fire and water  
- that pure and rarified place believed to have been inhabited by the heavenly  
bodies of ancient Greece.

55 metre QUINTA ESSENTIA is the largest and one of the most powerful  
Heesen yachts yet launched





## STYLE, SPEED AND SOPHISTICATION.

The all-aluminium Quintessence is truly striking, and - with a top speed of 24 knots - has so much more than just good looks.

Three expansive decks offer guests a wide variety of areas in which to relax, to take the sun and entertain.

The swimming pool, aft on the main deck, is constantly replenished by a sheet waterfall, and the sun deck features a jacuzzi adjoining a fully-equipped spa.







ENTERTAIN, RELAX AND EXPLORE.



Deck areas have been carefully planned to give maximum enjoyment and comfort, their unobstructed views emphasising the sense of spaciousness.

Entertain guests on the aftdeck before dinner, enjoy breakfast or an aperitif on the top deck, or sip a tantalising cocktail on the spa foredeck



DISCREETLY LUXURIOUS,  
ELEGANTLY INTIMATE.

...With a relaxing and liberating air of spaciousness, the rich cream salon is enlivened by a dash of deep aubergine and a scattering of bright florals.



## COMFORTABLE AND INVITING.

The interior is awash with natural light which pours in through the wide windows and generously proportioned balconies. A grand piano holds the promise of pleasurable evenings filled with music.







ON BOARD, FINE DINING IS  
TREATED LIKE A FINE ART.

A table laid to perfection, a top-class chef and silver spoon service, the dining experience on Quinta Essentia is unsurpassed.

The chef carefully selects the freshest ingredients to suit any dietary requirements or whims, any time of day or night. Entertain in supreme style, where attention to detail is the crew's priority.



AN APARTMENT WITH  
VOLUMINOUS PROPORTIONS.



Silver is the dominant colour in the owners' suite (forward on the main deck), reflecting the bold colours of the four earthly elements in the guest cabins - creating an interpretation of the mythical fifth element, the quinta essentia.

## SPACE AND ELEGANCE



The black, white and mirrored master bathroom combines modern and classic elements - a black stone bath tub and a wall of mirrors with silver leaf frames. The owner's suite also extends into an elegant and private bureau.



## INSPIRED BY THE ELEMENTS

The gloriously earthy, fiery, bright and cool hues of QUINTA ESSENTIA's impressive suite of guest cabins are dramatically offset by the pure white background.

Quinta Essentia offers accommodation for up to 10 guests in 5 suites: a VIP cabin, three double cabins and one triple cabin.



## GLAMOROUS AND SUMPTUOUS



Carpeting throughout is in hand-woven white silk, into which the designer Reverberi has introduced a single, tapering, wave-like brush-stroke, in shades to represent each element.

The doors to the guest rooms are decorative glass, hand-made at Pictet atelier.





## THE OCEAN IS A PLAYGROUND

With Quinta Essentia's selection of up-to-date waverunners, sea bobs and inflatables, guests can explore the coastline, or have an adrenalin-fuelled, action-packed day.

The yacht is the first in the Heesen fleet to sport a tender bay that can be flooded to allow easy launching and recovery.





## WORK OUT, RELAX AND UNWIND.

QUINTA ESSENTIA has a fully equipped gym with a 180-degree view of the ocean. The latest fitness machines ensure an efficient and effective workout, with the finest in high definition entertainment.

The onboard professional masseuse caters for those in search of a more soothing and therapeutic experience. Let off some steam in the sauna or scrub down in the fragrant hammam.



An atrium of decorative glass, rising through three levels from the main deck, encompasses a spiral staircase and an elevator of glass and stainless steel.





## SPECIFICATIONS

length:	55.0m
beam:	9.4m
draft:	3.0m
year:	2011
builder:	Heesen Yachts
status:	MCA / Commercial
cruising speed:	18 knots
max speed:	24 knots
flag:	Red Ensign
port of registry:	George Town, Cayman Islands
crew:	14
guests sleeping:	12
main engines:	2 MTU 16V595TE90 (4.190 kW at 1.900 rpm) diesel engines, with two five blade Nibral Bronze propellers
generators:	Main generators 2 x Kilopak 175 kW @ 50 Hz, Emergency generator 1 x Kilopak 85kW @ 50Hz
communication:	VSAT, Fleet Broadband, Sat C, 3G
entertainment:	Kaleidescape AOD/VOD. Controlled by Crestron processors with Crestron touchpanels

photography by Emilio Bianchi, Carlo Borlenghi, Martin Morrell  
 design and production by www.QLuxuryMedia.com

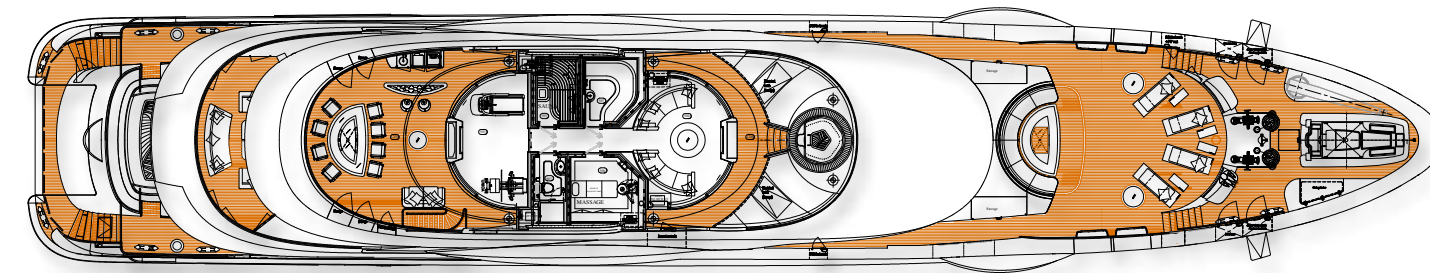

TOP DECK

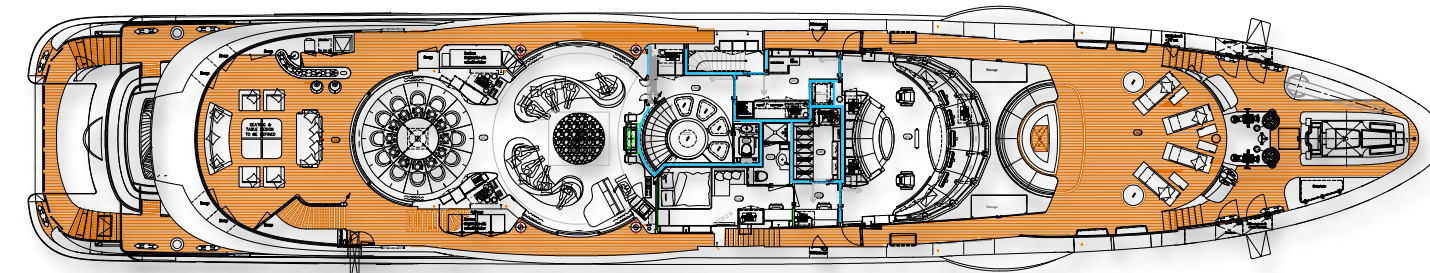

OWNER'S DECK

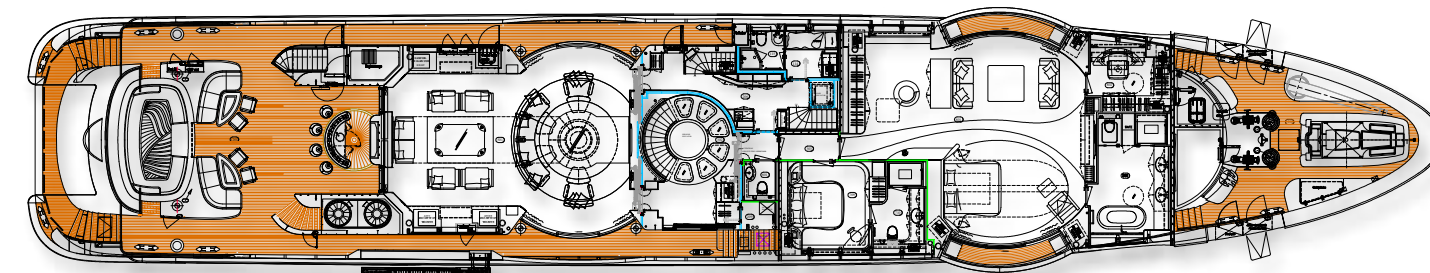

MAIN DECK

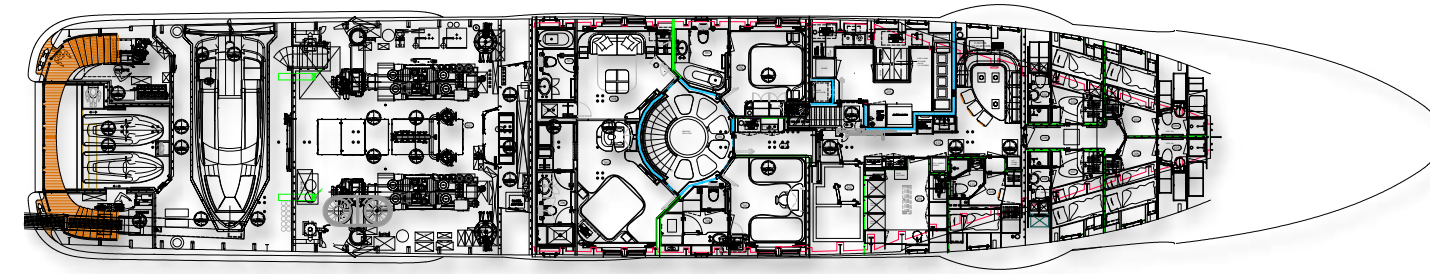

LOWER DECK





